

PIT SCHEDULE										
PIT No.	TYPE	PIT DIMENSIONS			PIT LEVELS		PIT LOCATION		FACE BRG	COMMENTS
		L	W	D	INVERT	TOP	EASTING	NORTHING		
X16	Ex JP	-	-	-	448.601	-	745665.277	5841432.938	-	-
X17	JP	900	600	1.180	448.800	449.980	745682.917	5841464.035	240°26'08"	-
X18	JP	900	600	0.681	449.423	450.104	745712.672	5841516.489	240°26'08"	-
X33	Ex JP	-	-	-	447.821	-	745786.511	5841537.920	-	-
X33-1	SEP	900	750	1.030	447.959	448.989	745771.898	5841527.414	240°26'08"	-
X33-1-1	SEP	900	750	0.900	448.086	448.986	745764.374	5841531.681	60°26'08"	-
X33-1-2	SEP	900	750	0.741	448.520	449.261	745761.542	5841541.942	150°15'27"	-
X33-2	SEP	900	750	1.007	448.127	449.134	745757.257	5841501.604	240°26'08"	-
X33-3	SEP	900	750	0.900	448.234	449.134	745749.734	5841505.872	60°26'08"	-
X34	JP	900	900	1.569	448.279	449.848	745737.932	5841565.478	60°26'35"	PROVIDE STEP IRONS.

NOTE: SETOUT POINTS ARE TO CENTRE OF BASE OF PIT

- General Notes
1. ALL HD CONNECTIONS WITH CHAINAGES TO CONNECT TO UNDERGROUND DRAINAGE
 2. RUNNING CHAINAGE OF HD TAKEN FROM NEXT DOWNSTREAM PIT
 3. SUBSURFACE DRAINS TO OUTLET TO DRAINAGE PITS
 4. ROAD DIMENSIONS ARE TO INVERT OF KERB

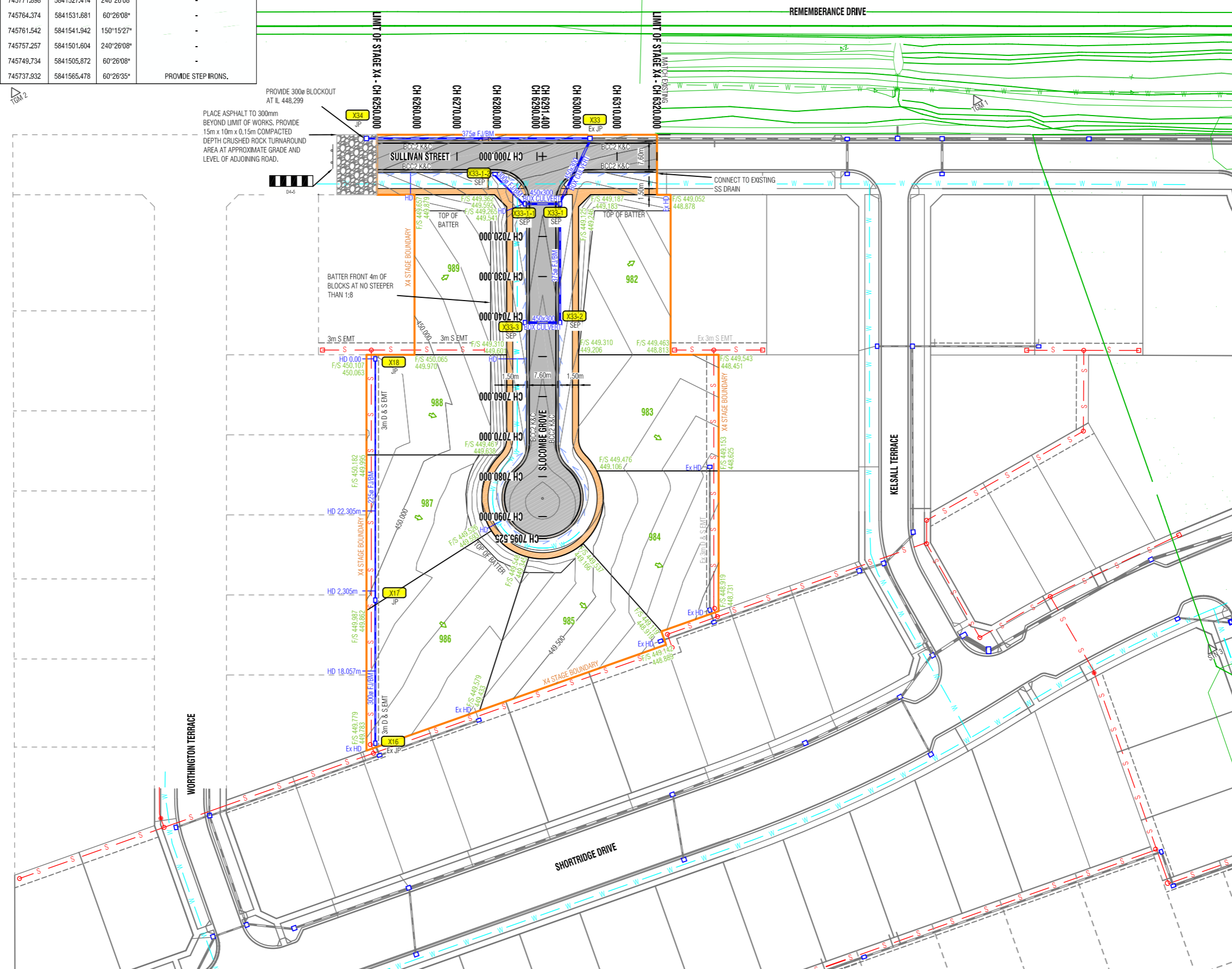

PROVIDE 300mm BLOCKOUT AT IL 448.299
 PLACE ASPHALT TO 300mm BEYOND LIMIT OF WORKS. PROVIDE 15m x 10m x 0.15m COMPACTED DEPTH CRUSHED ROCK TURNAROUND AREA AT APPROXIMATE GRADE AND LEVEL OF ADJOINING ROAD.

BATTER FRONT 4m OF BLOCKS AT NO STEEPER THAN 1:8

CONNECT TO EXISTING SS DRAIN

LEGEND	
	SEWER PITS
	SEWER MAIN
	DRAINAGE PITS
	DRAINAGE PIPE
	SUBSURFACE DRAIN
	WATER MAIN
	FINISHED SURFACE LEVEL
	EXISTING SURFACE LEVEL
	RUNNING CHAINAGE OF HD
	FOOTPATH / DRIVEWAY
	ASPHALT

WARNING
 BEWARE OF UNDERGROUND SERVICES
 THE LOCATIONS OF UNDERGROUND SERVICES ARE APPROXIMATE ONLY AND THEIR EXACT POSITION SHOULD BE PROVEN ON SITE. NO GUARANTEE IS GIVEN THAT ALL EXISTING SERVICES ARE SHOWN

SAFETY FIRST
 SAFETY STARTS WITH YOU

Rev	Amendment	Initials	Date
4			
3			
2	ISSUED FOR CHECKING		04/01/17
1	ISSUED FOR COMMENT	SH	13/12/16

Integra

1728 Sturt St, Alfredton
 Post Office Box 4226
 Alfredton Victoria 3350
 T: 03 5322 5999 F: 03 5322 5995

Project
LUCAS ESTATE
 RESIDENTIAL SUBDIVISION
 STAGE X4
 LUCAS, VIC

Authority
 Ballarat City Council - (03) 5320 5500

Drawing Title
DRAINAGE PLAN

Status
PRELIMINARY
 NOT FOR CONSTRUCTION

Designer
 S.HOOPER

Checker
 T.OLDAKER

Scale (A1) 1:500 Scale (A3) 1:1000

HDR 0 5 10 15 20 25
 VER

Sheet Number
4 of 8

Drawing Number
LUX4-CD-004

Revision
2