

CONTENTS:

Drawing Number
PLA074-L01 Context and Contents Plan
PLA074-L02 Sheet Layout and Plant Schedule
PLA074-L03 Street Tree Plan 01
PLA074-L04 Street Tree Plan 02

TP1	Town Planning Issue	AD	30.09.15
P1	Preliminary Issue	AD	21.09.15
	Revision	Description	Date
APPROVAL ISSUE			

- Notes**
- All dimensions to be checked on site before commencing work. All measurements are in metres, unless otherwise shown.
 - The locations of underground services and light poles are indicative only - refer to engineering drawings for design service offsets.
 - The location and depth of services shall be verified on site prior to the commencement of works. The Contractor shall be liable for any damage to services during the landscape works.
 - Standard Street Tree Offsets.
 - Standard offset from the back of kerb is 1.2m unless otherwise shown.
 - Minimum setback of 2.0m to service assets including pits and conduit crossings.
 - Minimum setback of 2.0m to domestic service tapping points and stormwater outlets.
 - Minimum setback of 1.2m to footpath crossings and 3.0m to driveways where they are existing or known.
 - Minimum setback of 3.0m to fire hydrants.
 - Minimum setback of 5.0m to light poles.
 - Proposed Street Trees.
 - Species are in general accordance with the Lucas Landscape Masterplan, Precinct C (dated 02 July 2015).
 - Trees are planted to allow a driveway within 7.0m from the Title Boundary where possible.
 - Tree position in front of lots may change slightly due to 'actual' location of services, and constructed driveway crossings.
 - Setback from intersection (kerb) shall be a minimum of 10m in accordance with City of Ballarat Landscape Design Manual (LDM).
 - Planting. All trees, shrubs and groundcovers shall be planted in accordance with LDM, unless otherwise specified.
 - Mulch. Mulch shall be recycled hardwood (or similar approved) in general accordance with LDM, unless otherwise specified.
 - Grass Seeding. Reseed nature strips and other grassed areas where there has been disturbance due to landscape works with a 50:50 eye:couch mix, unless otherwise specified.

Planning and Environment Act 1987
 BALLARAT PLANNING SCHEME
 This plan is endorsed as forming part of
 Planning Permit No. PP/2014/298
 Planning Permit Issue Date 19/06/2014
 Plan 1 of 4
 Signed [Signature]
 Authorised Officer for and on behalf of
 CITY OF BALLARAT
 Date 19/10/2015



Client / Project:
Integra
 Stage C2
 Lucas, Ballarat

Context and Contents Plan			
Approved:	AD	Date:	30.09.15
Scale (NTS):	NTS	Scale (AS):	1 of 4
<small>This drawing and design is protected by copyright © PLOT Landscape Architects Pty Ltd. E. integra@plota.com.au P. 0428 397 304</small>			
Drawing Number:	PLA074-L01	Revision:	TP1

CONTEXT PLAN - Stage C2 Lucas (nts)

Notes

- All dimensions to be checked on site before commencing work. All measurements are in metres, unless otherwise shown.
- The locations of underground services and light poles are indicative only - refer to engineering drawings for design service offsets.
- The location and depth of services shall be verified on site prior to the commencement of works. The Contractor shall be liable for any damage to services during the landscape works.
- Standard Street Tree Offsets.
 - Standard offset from the back of kerb is 1.2m unless otherwise shown.
 - Minimum setback of 2.0m to service assets including pits and conduit crossings.
 - Minimum setback of 2.0m to domestic service lapping points and stormwater outlets.
 - Minimum setback of 1.2m to footpath crossings and 3.0m to driveways where they are existing or known.
 - Minimum setback of 3.0m to fire hydrants.
 - Minimum setback of 5.0m to light poles.
- Proposed Street Trees.
 - Species are in general accordance with the Lucas Landscape Masterplan, Precinct C (dated 02 July 2015).
 - Trees are planted to allow a driveway within 7.0m from the Title Boundary where possible.
 - Tree position in front of lots may change slightly due to 'actual' location of services, and constructed driveway crossings.
 - Setback from intersection (kerb) shall be a minimum of 10m in accordance with City of Ballarat Landscape Design Manual (LDM).
- Planting. All trees, shrubs and groundcovers shall be planted in accordance with LDM, unless otherwise specified.
- Mulch. Mulch shall be recycled hardwood (or similar approved) in general accordance with LDM, unless otherwise specified.
- Grass Seeding. Reseed nature strips and other grassed areas where there has been disturbance due to landscape works with a 50:50 ryegrass:couch mix, unless otherwise specified.

Master Plant Schedule - Stage C2, Lucas

Code	Botanical Name	Common Name	Plant Size	Qty
Trees				
CMA	<i>Corymbia maculata</i>	Spotted Gum	16 ltr cont.	5
FPC	<i>Fraxinus pennsylvanica 'Cimmaron'</i>	Cimmaron™ Ash	40 ltr cont.	5
LHN	<i>Lagerstroemia hybrid 'Natchez'</i>	Crepe Myrtle 'Natchez'	40 ltr cont.	6
UPA	<i>Ulmus parvifolia</i>	Chinese Elm	40 ltr cont.	18

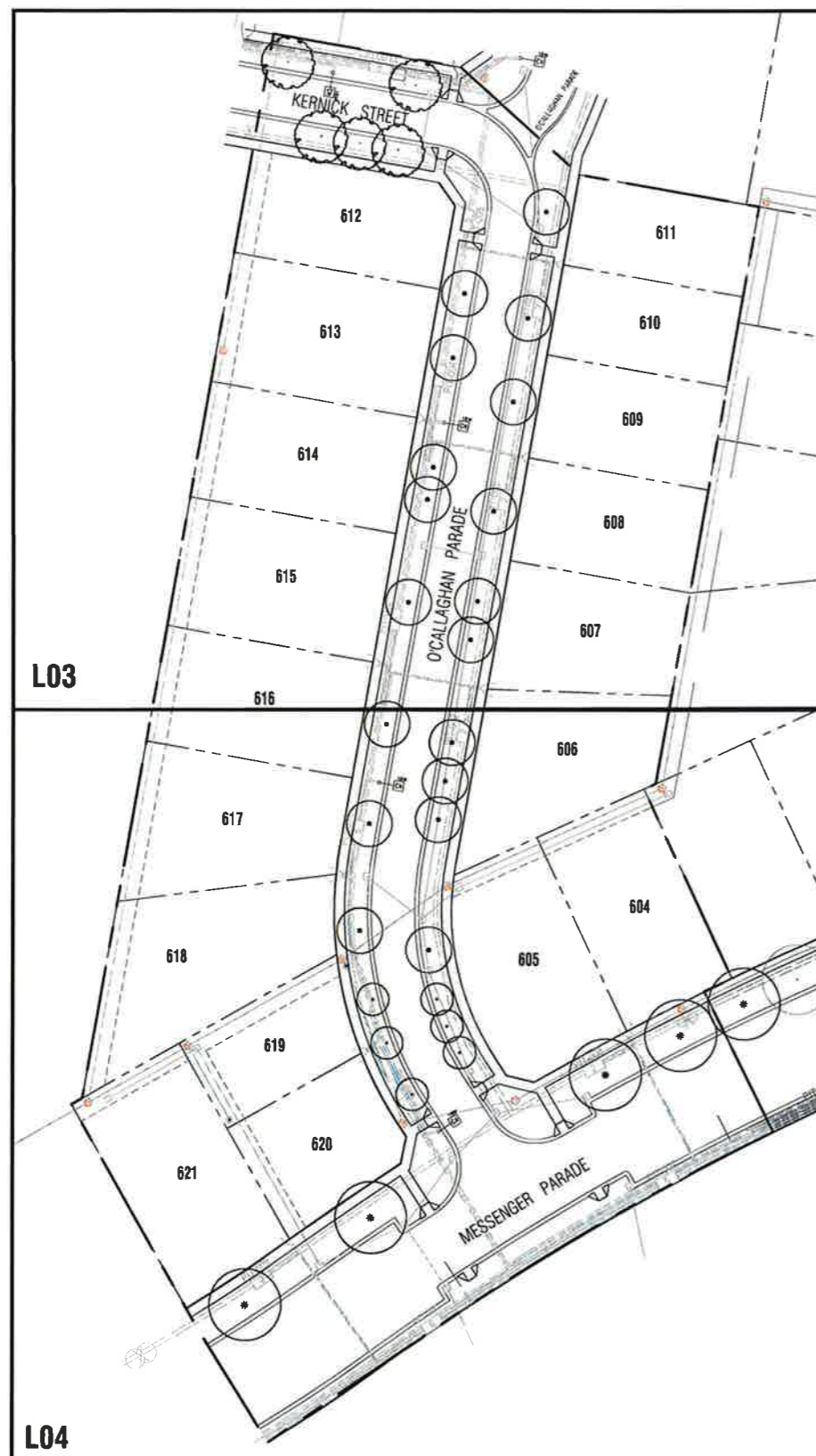

SHEET LAYOUT PLAN - Stage C2, Lucas

Planning and Environment Act 1987
 BALLARAT PLANNING SCHEME
 This plan is endorsed as forming part of
 Planning Permit No. PU/2014/298
 Planning Permit Issue Date 19/06/2014
 Plan 2 of 4
 Signed [Signature]
 Authorised Officer for and on behalf of
 CITY OF BALLARAT
 Date 19/10/2015



Client / Project:
 Integra
 Stage C2
 Lucas, Ballarat

Sheet Layout and Plant Schedule

Approved: AD Date: 30.09.15
 Scale (A1): 1:500 Scale (A3): 1:1000 Sheet: 2 of 4

This drawing and design is protected by copyright © PLOT Landscape Architects Pty Ltd. E: angela@plota.com.au P: 0428 327 304

A	Town Planning Approval	AD	30.09.15
P1	Preliminary Issue	AD	21.09.15
Revision	Description	Initials	Date
Status	APPROVAL ISSUE		

- Notes**
- All dimensions to be checked on site before commencing work. All measurements are in metres, unless otherwise shown.
 - The locations of underground services and light poles are indicative only - refer to engineering drawings for design service offsets.
 - The location and depth of services shall be verified on site prior to the commencement of works. The Contractor shall be liable for any damage to services during the landscape works.
 - Standard Street Tree Offsets.
 - Standard offset from the back of kerb is 1.2m unless otherwise shown.
 - Minimum setback of 2.0m to service assets including pits and conduit crossings.
 - Minimum setback of 2.0m to domestic service tapping points and stormwater outlets.
 - Minimum setback of 1.2m to footpath crossings and 3.0m to driveways where they are existing or known.
 - Minimum setback of 3.0m to fire hydrants.
 - Minimum setback of 5.0m to light poles.
 - Proposed Street Trees.
 - Species are in general accordance with the Lucas Landscape Masterplan, Precinct C (dated 02 July 2015).
 - Trees are planted to allow a driveway within 7.0m from the Title Boundary where possible.
 - Tree position in front of lots may change slightly due to 'actual' location of services, and constructed driveway crossings.
 - Setback from intersection (kerb) shall be a minimum of 10m in accordance with City of Ballarat Landscape Design Manual (LDM).
 - Planting. All trees, shrubs and groundcovers shall be planted in accordance with LDM, unless otherwise specified.
 - Mulch. Mulch shall be recycled hardwood (or similar approved) in general accordance with LDM, unless otherwise specified.
 - Grass Seeding. Reseed nature strips and other grassed areas where there has been disturbance due to landscape works with a 50:50 ryegrass:couch mix, unless otherwise specified.

- Legend**
- Proposed Street Trees - *Ulmus parvifolia* (Chinese Elm)
 - Proposed Street Trees - *Fraxinus pennsylvanica* 'Climmzar' (Climmzar™ Ash)
 - Plant Label and Code

Planning and Environment Act 1987
 BALLARAT PLANNING SCHEME
 This plan is endorsed as forming part of
 Planning Permit No. PLP/2014/298
 Planning Permit Issue Date 19/06/2014
 Plan STAGE C1 3 of 4
 Signed [Signature]
 Authorised Officer for and on behalf of
 CITY OF BALLARAT
 Date 19/10/2015



Client / Project:
Integra
 Stage C2
 Lucas, Ballarat

Drawing Title:
Street Tree Plan 01

Approved: AD Date: 30.09.15 North
 Scale (A1): 1:200 Scale (A3): 1:400 Sheet: 3 of 4

This drawing and design is protected by copyright © PLOT Landscape Architects Pty Ltd. E. angrita@plota.com.au P. 0428 327 304

Drawing Number: **PLA074-L03** Revision: **TP1**

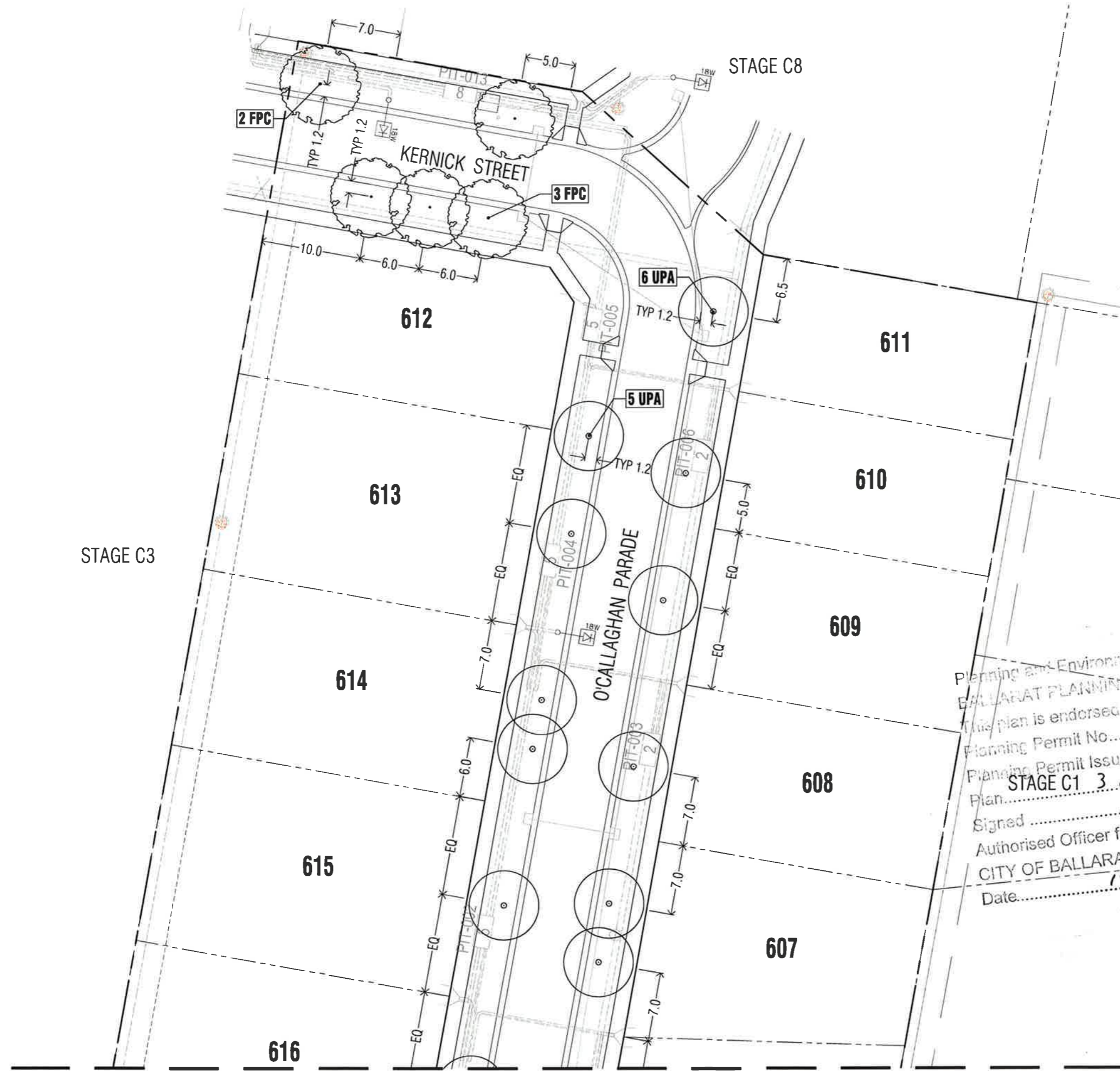

Continued on L04

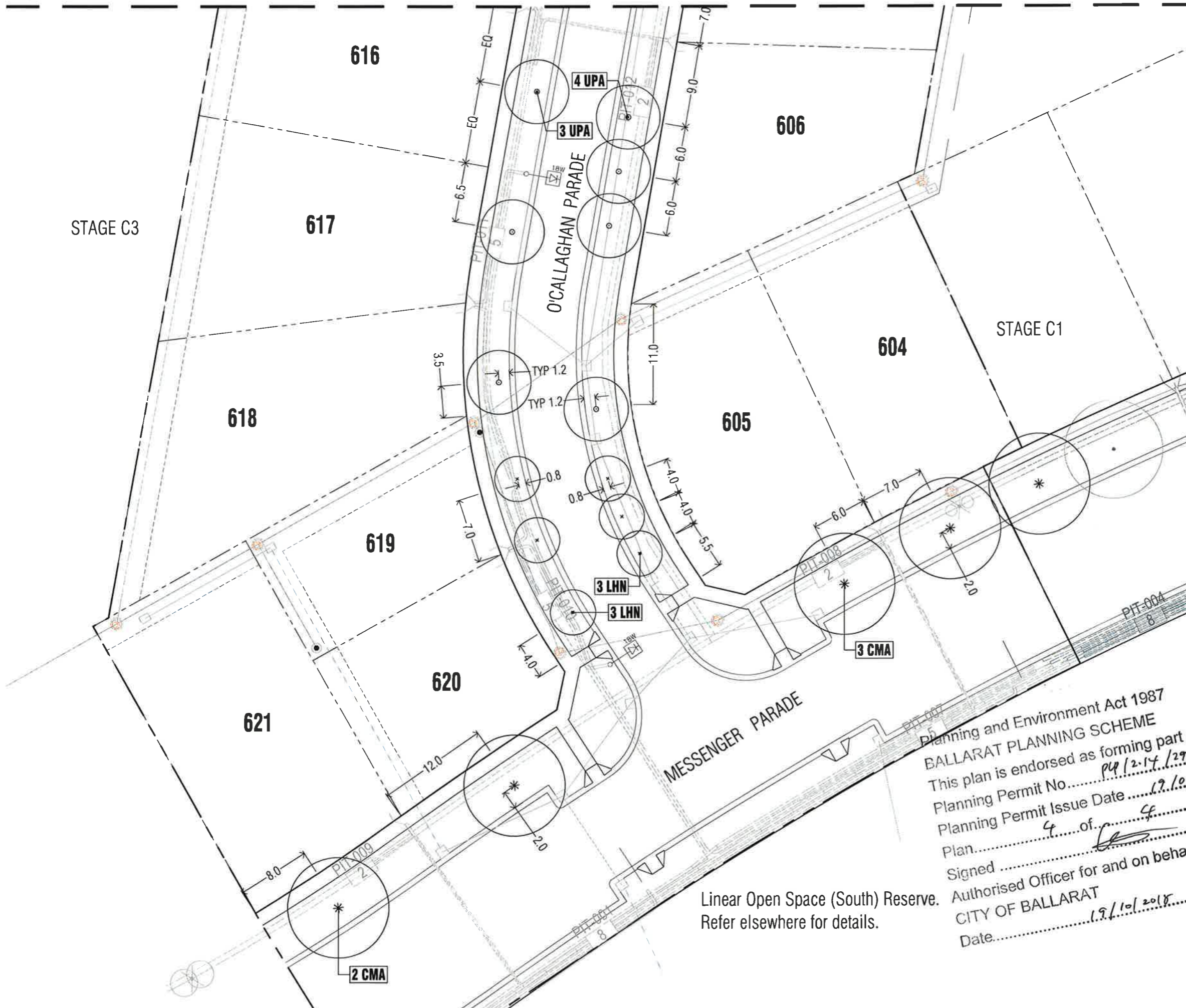

A	Town Planning Approval	AD	30.09.15
P1	Preliminary Issue	AD	21.09.15
Revision	Description	Issue	Date
APPROVAL ISSUE			

- Notes**
- All dimensions to be checked on site before commencing work. All measurements are in metres, unless otherwise shown.
 - The locations of underground services and light poles are indicative only - refer to engineering drawings for design service offsets.
 - The location and depth of services shall be verified on site prior to the commencement of works. The Contractor shall be liable for any damage to services during the landscape works.
 - Standard Street Tree Offsets.
 - Standard offset from the back of kerb is 1.2m unless otherwise shown.
 - Minimum setback of 2.0m to service assets including pits and conduit crossings.
 - Minimum setback of 2.0m to domestic service lapping points and stormwater outlets.
 - Minimum setback of 1.2m to footpath crossings and 3.0m to driveways where they are existing or known.
 - Minimum setback of 3.0m to fire hydrants.
 - Minimum setback of 5.0m to light poles.
 - Proposed Street Trees.
 - Species are in general accordance with the Lucas Landscape Masterplan, Precinct C (dated 02 July 2015).
 - Trees are planted to allow a driveway within 7.0m from the Title Boundary where possible.
 - Tree position in front of lots may change slightly due to 'actual' location of services, and constructed driveway crossings.
 - Setback from intersection (kerb) shall be a minimum of 10m in accordance with City of Ballarat Landscape Design Manual (LDM).
 - Planting. All trees, shrubs and groundcovers shall be planted in accordance with LDM, unless otherwise specified.
 - Mulch. Mulch shall be recycled hardwood (or similar approved) in general accordance with LDM, unless otherwise specified.
 - Grass Seeding. Reseed nature strips and other grassed areas where there has been disturbance due to landscape works with a 50:50 rye:couch mix, unless otherwise specified.

Legend

	Tree planted as part of another stage of works.
	Proposed Street Trees - <i>Ulmus parvifolia</i> (Chinese Elm)
	Proposed Street Trees - <i>Lagerstroemia hybrid 'Natchez'</i> (Crape Myrtle)
	Proposed Street Trees - <i>Corymbia maculata</i> (Spotted Gum)
	Plant Label and Code

Planning and Environment Act 1987
 BALLARAT PLANNING SCHEME
 This plan is endorsed as forming part of
 Planning Permit No. PP12.17/298
 Planning Permit Issue Date 19/06/2014
 Plan 9 of 9
 Signed [Signature]
 Authorised Officer for and on behalf of
 CITY OF BALLARAT
 Date 19/10/2018



Client / Project: **Integra**
 Stage C2
 Lucas, Ballarat

Drawing Title: **Street Tree Plan 02**

Approved	Date	Month
AD	30.09.15	
Scale (A1)	Scale (A3)	Sheet
1:200	1:400	4 of 4

This drawing and design is protected by copyright © PLOT Landscape Architects Pty Ltd. E. angela@plota.com.au P. 0428 327 304

Drawing Number: **PLA074-L04** Revision: **TP1**